



-Mise en conformité  
et restructuration du collège

-Installation définitive du Centre de  
Formation



Avant travaux >

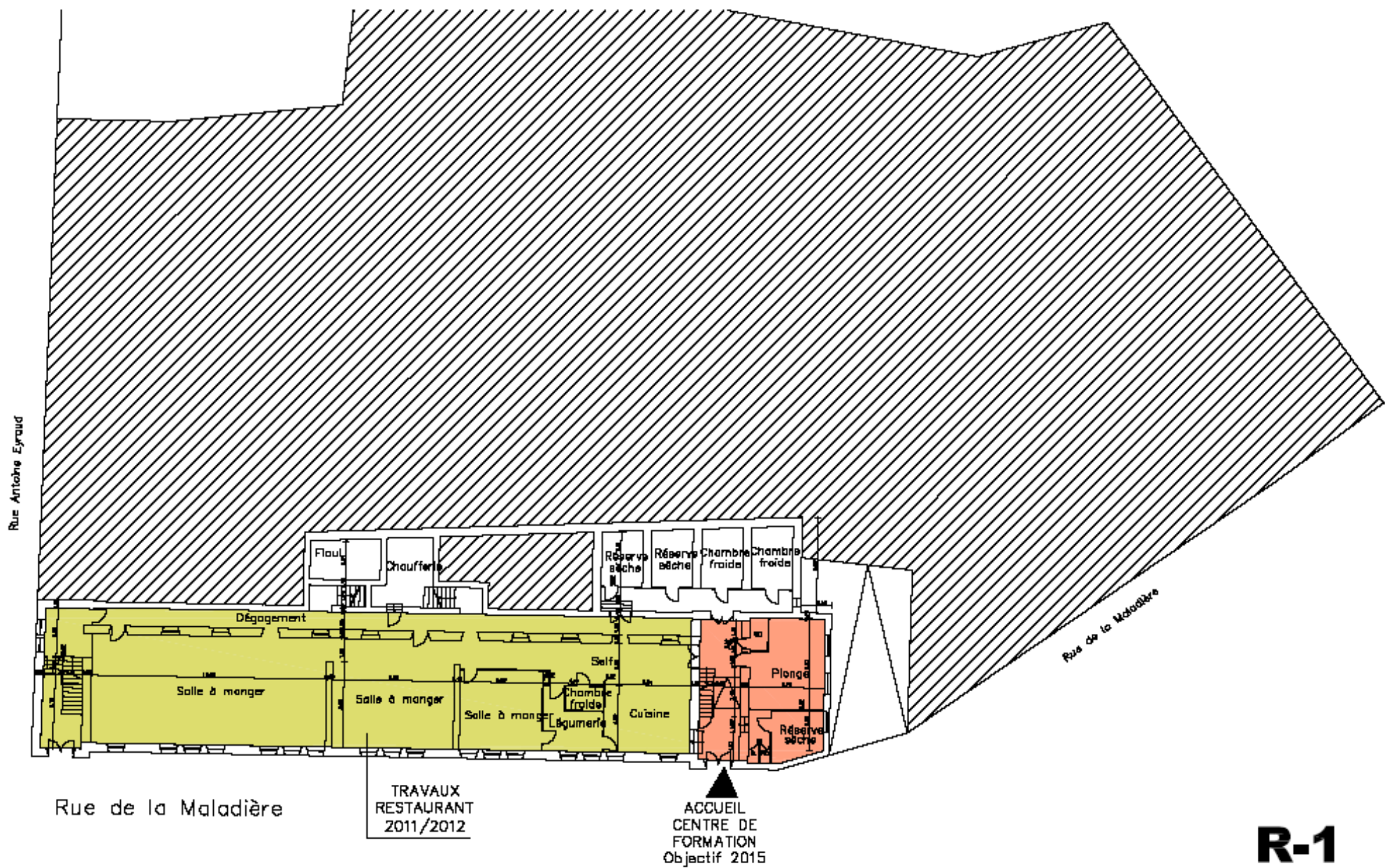



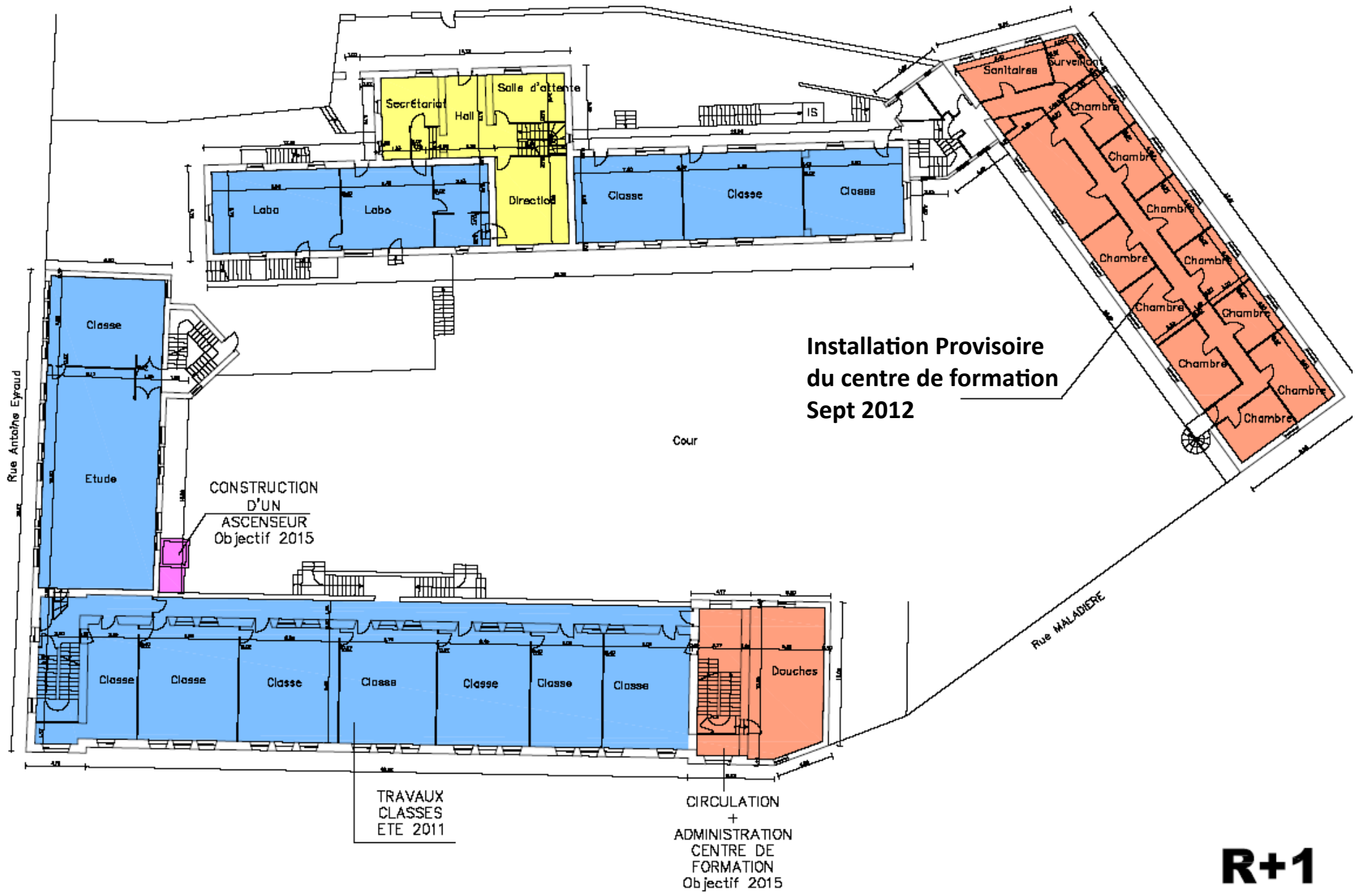

**Installation Provisoire  
du centre de formation  
Sept 2012**

**R+1**

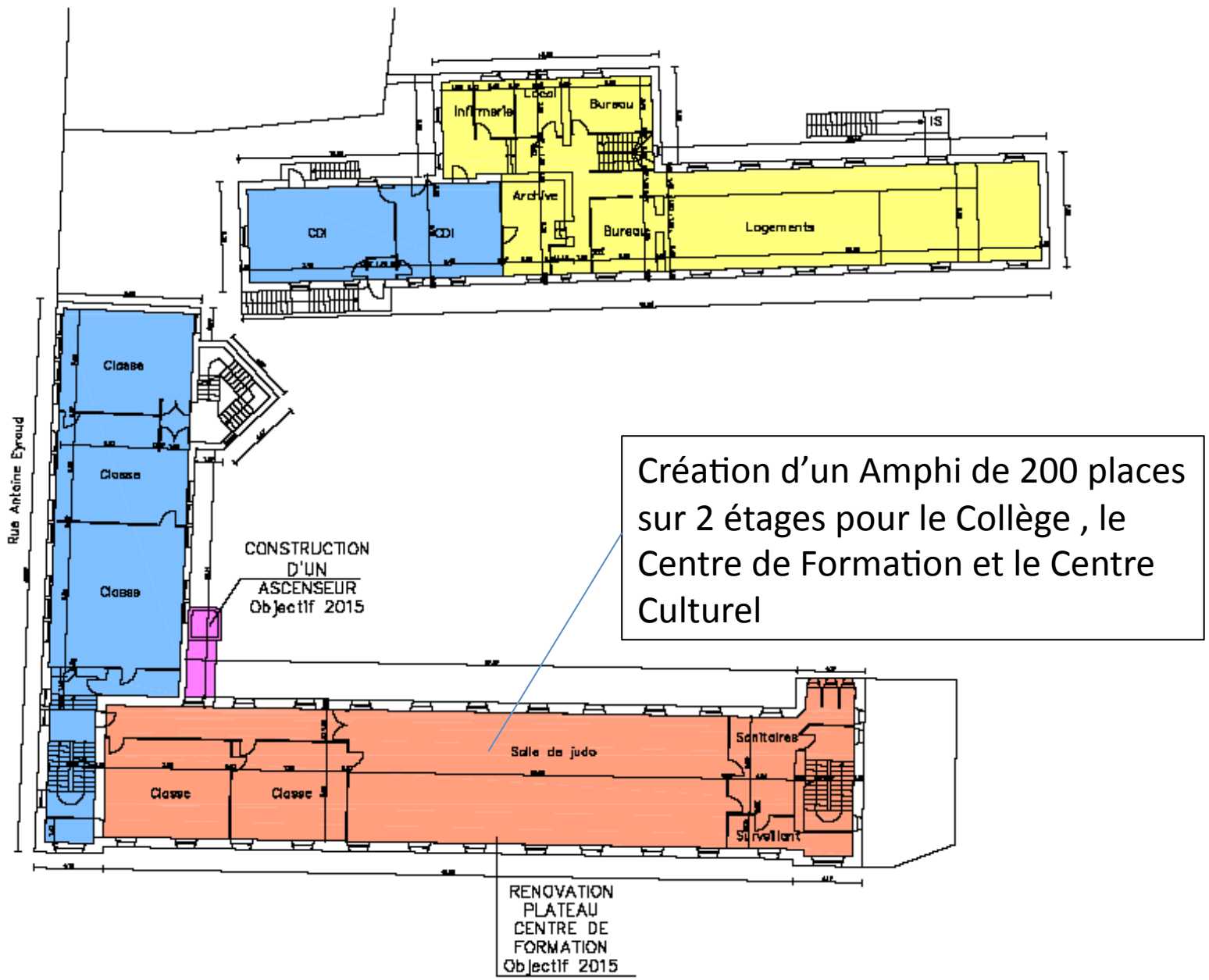

## Centre de formation

Surface : 700 à 800 m<sup>2</sup>

## Internats

Surface: 400 à 500 m<sup>2</sup>

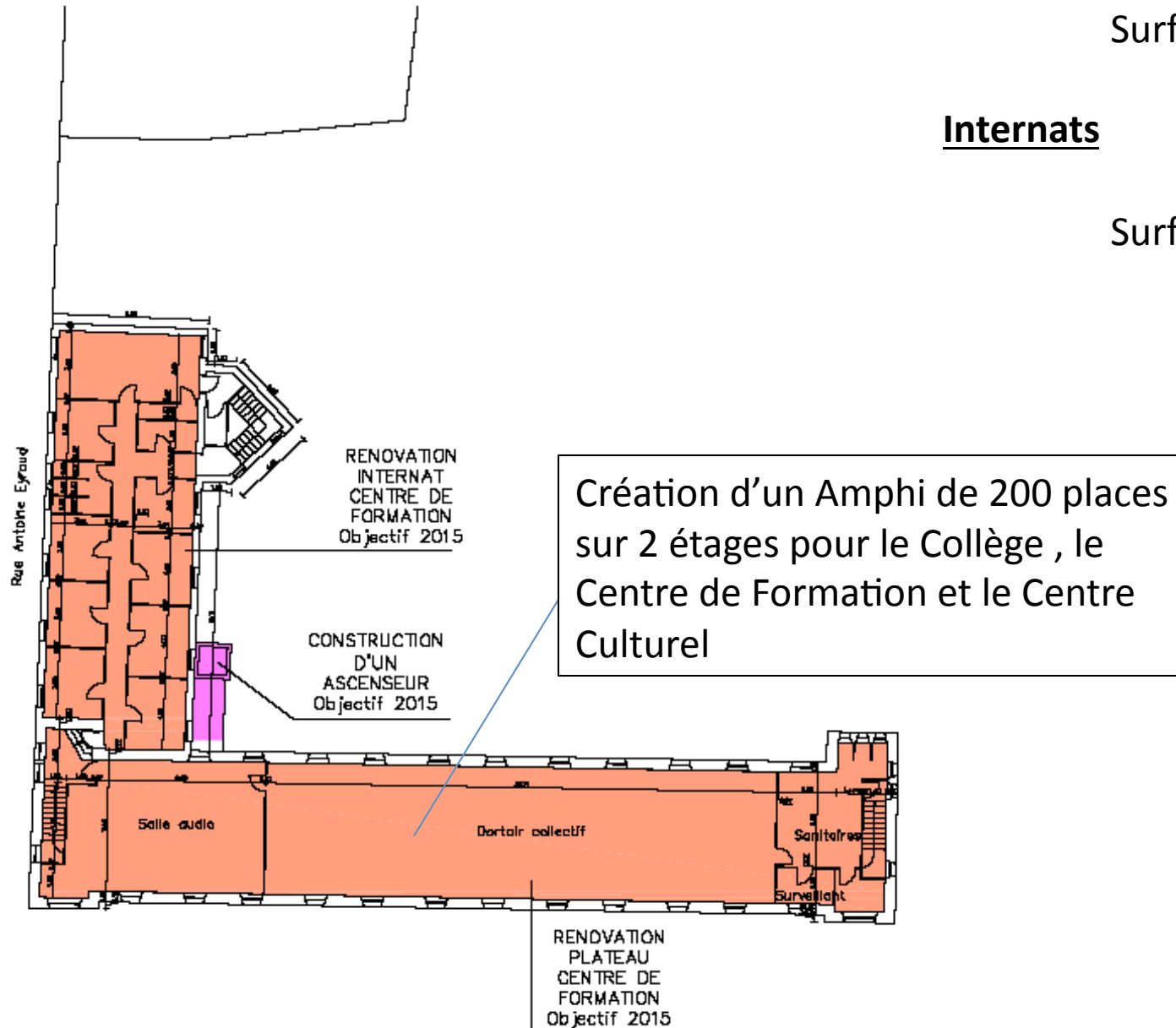

**R+3**